

One

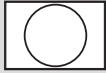

Available Screen Materials

White



The screen fabric has a matt white surface.

Greylight (gain 0.93)



The screen fabric has a high contrast matt grey surface.

Greyline (gain 0.8)



The screen fabric has a high contrast matt grey surface.

ReAct

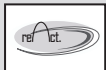

Maximal contrast and optimal colour rendition in even ambient light environments.

Rear Projection



Grey rear projection diffusing surface. Provides high resolution and excellent contrast.

Acoustic



White sound transparent material which provides 180° viewing angle.

Available Formats

1 : 1
SQUARE

The screen format is 1:1. No black borders.

4 : 3
VIDEO

The screen has 5 cm wide black borders. The format of the viewing area is 4:3.

16 : 9
WIDE

The screen has 5 cm wide black borders. The format of the viewing area is 16:9.

2.35 : 1
CINEMASCOPE

The screen has 5 cm wide black borders. The format of the viewing area is 2.35:1.

One is a high quality screen with exclusive design – the architect's choice. It is also very popular as a complement to a white board since the "floating" case, made of anodized aluminium, brings the screen in front of the white board. The installation is very flexible with mounting brackets that can be adjusted sideways to preferred positions and the screen can be mounted on the wall as well as in the ceiling.

Screen Dimensions

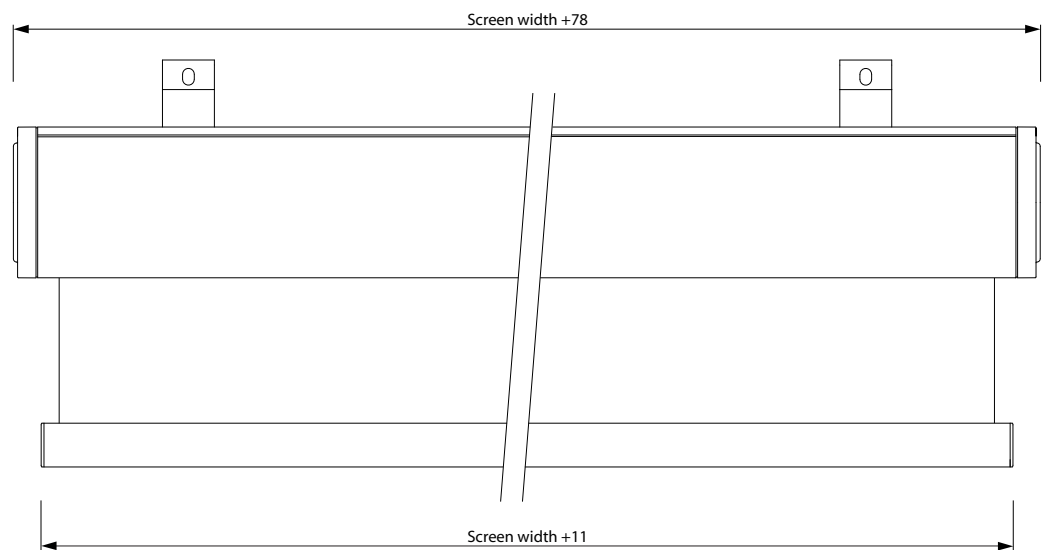

Example – One Dimensions

Model: O1617-V

Screen width: 1600mm

Total width: 1600 mm + 78 mm = 1678 mm

Bar width: 1600 mm + 11 mm = 1611 mm

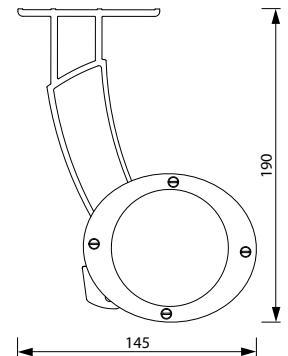
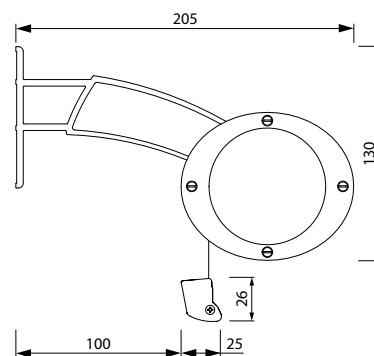
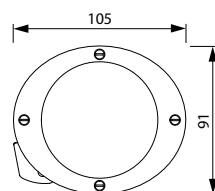

All dimensions in this document are in mm

Document PDSO ver 1.1, page 1 of 2



Bjurab Sweden AB
Kristinebergsvägen 22
SE-302 41 Halmstad
Sweden

Tel: +46 – 35 – 144290
Fax: +46 – 35 – 144291
Email: info@bjurab.se
Web: www.bjurab.se

Bracket Dimensions

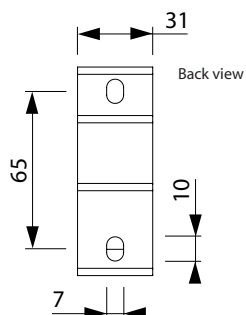
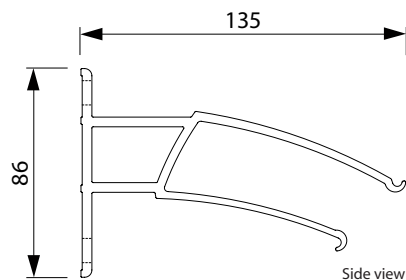

Packaging Dimensions

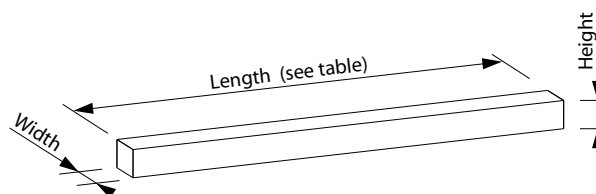

Screen width	Box length	Box width	Box height
1600	1890	185	115
1800	2090	185	115
2000	2290	185	115
2200	2490	185	115
2400	2690	185	115
2700	2990	185	115
3000	3290	185	115

Article Numbers for One

Square Format, 1 : 1

ART. NO	SCREEN SIZE WIDTH x HEIGHT	WT. KG
O160	1600 x 1600	
O180	1800 x 1800	
O200	2000 x 2000	
O220	2200 x 2200	
O240	2400 x 2400	
O270	2700 x 2700	
O300	3000 x 3000	

Video Format, 4 : 3

ART. NO	SCREEN SIZE WIDTH x HEIGHT	VIEW AREA WIDTH x HEIGHT	WT. KG
O1617-V	1600 x 1850	1500 x 1125	
O1817-V	1800 x 1850	1700 x 1275	
O2017-V	2000 x 1850	1900 x 1425	
O2217-V	2200 x 1800	2100 x 1575	
O2420-V	2400 x 2050	2300 x 1725	
O2724-V	2700 x 2250	2600 x 1950	
O3024-V	3000 x 2350	2900 x 2175	

Wide Format, 16 : 9

ART. NO	SCREEN SIZE WIDTH x HEIGHT	VIEW AREA WIDTH x HEIGHT	WT. KG
O1617-W	1600 x 1850	1500 x 845	
O1817-W	1800 x 1850	1700 x 955	
O2017-W	2000 x 1850	1900 x 1070	
O2217-W	2200 x 1800	2100 x 1180	
O2417-W	2400 x 1800	2300 x 1295	
O2724-W	2700 x 2050	2600 x 1460	
O3024-W	3000 x 2050	2900 x 1630	

All weights are gross (total weight including packaging, brackets etc.).

Standard screen material is white. Screens with Greylight, Greyline, ReAct, Rear Projection and Acoustic fabric are available in sizes with maximum height of 2400 mm.

For article numbers with Greylight replace O by OG. Example: An 2217-W with Greylight fabric = OG2217-W

For article numbers with Greyline replace O by OGL. Example: An 2217-W with Greyline fabric = OGL2217-W

For article numbers with ReAct replace O by OS. Example: An 2217-W with ReAct fabric = OS2217-W

For article numbers with Rear Projection replace O by OR. Example: An 200 with Rear Projection = OR200

For article numbers with Acoustic replace O by OA. Example: An 2217-W with Acoustic fabric = OA2217-W

For article numbers with CinemaScope (2.35:1), please see our pricelist.

Accessories

ARTICLE NO

400300 Screen Cleaning Spray, 250 ml

